

Hudson River PCBs Superfund Site



Community Advisory Group Meeting
September 27, 2007



Hudson River
PCBs SUPERFUND SITE

Unexploded Ordnance (UXO) Site Discovery at Processing Facility



Unexploded Ordnance (UXO)

- **UXO information**
 - Found August 24, 2007
 - Over 800 sticks of dynamite in wooden cases
 - Dynamite was generally in good condition
- **Emergency Response**
 - Followed CHASP
- **Area Secured**



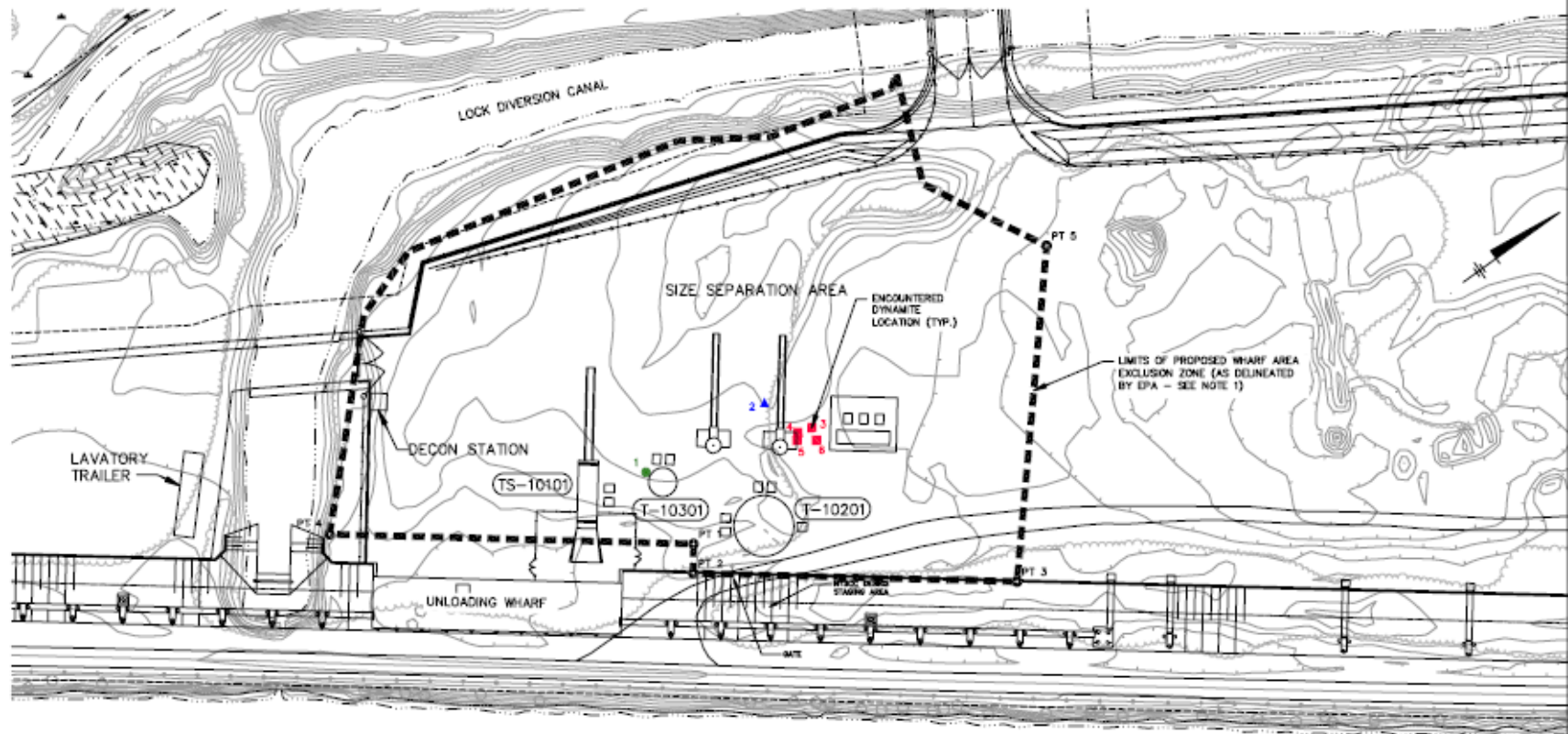

SYMBOL	ID	DESCRIPTION	DATE ENCOUNTERED
●	1	DYNAMITE LAST FOUND	8/27/2007
▲	2	SINGLE CASE OF DYNAMITE	8/24/2007
■	3	DYNAMITE GROUP	8/24/2007
■	4	DYNAMITE GROUP	8/24/2007
■	5	DYNAMITE GROUP	8/24/2007
■	6	DYNAMITE GROUP	8/24/2007

POINT ID	NORTHING	EASTING
PT 1	1820630.969	741353.874
PT 2	1820639.722	741367.834
PT 3	1820784.459	741485.015
PT 4	1820463.989	741222.083
PT 5	1820614.348	741333.841

SITE PLAN
SCALE: 1" = 30'

NOTE:
1. FIGURE PREPARED AT THE REQUEST OF EPA'S ONSITE REPRESENTATIVE. WHARF AREA EXCLUSION ZONE LIMITS AND COORDINATE POINT INFORMATION ARE BASED ON INFORMATION PROVIDED BY, DELINEATED BY, AND REQUESTED BY EPA'S ONSITE REPRESENTATIVE.

← CHAMPLAIN CANAL

GENERAL ELECTRIC COMPANY
HUDSON RIVER PCBs SUPERFUND SITE

**PROPOSED WHARF AREA
EXCLUSION ZONE**

ARCADIS of New York, Inc.



FIGURE
1





08/24/2007









Unexploded Ordnance (UXO)

- Areas nearby have been approved for continued work
- Next Steps:
 - UXO specialist on-site for future work
 - Develop work plan to clear the area
 - Amend Health and Safety Plan
 - Clear area for remaining construction earth work

Questions / Comments



Short-Term Response Action Upper Hudson River Floodplain



Summary of Response Action

- Response actions at certain properties previously sampled by EPA and GE
- Response action plan approved by EPA January 2007
- Response action includes
 - Installation of warning signs and/or installation of an isolation cover over the PCB-containing soils in the identified recreational use areas
 - Monitoring and maintenance of signs and covers

Summary of Response Action

- **The Project Area encompasses**
 - **Portions of River Sections 1 and 2 (including islands)**
 - **Limited portion of River Section 3 (just south of Champlain Canal Lock 5)**

Response Action Areas

- The areas subject to short-term response actions include
 - Transect 8E
 - Transect 9E
 - Transect 10E
 - Northern Island at RM 192
 - Transect 11E
 - Parcel on northern end of the Middle Island at RM 192

Response Action Areas

- Transect 12E
- Transect 13E
- Southern Island at RM 192
- Transect 26W-27W
- Transect 34E-36E
- Transect 37E (mainland)
- Transect 37E (island)
- Transect 42W-43W

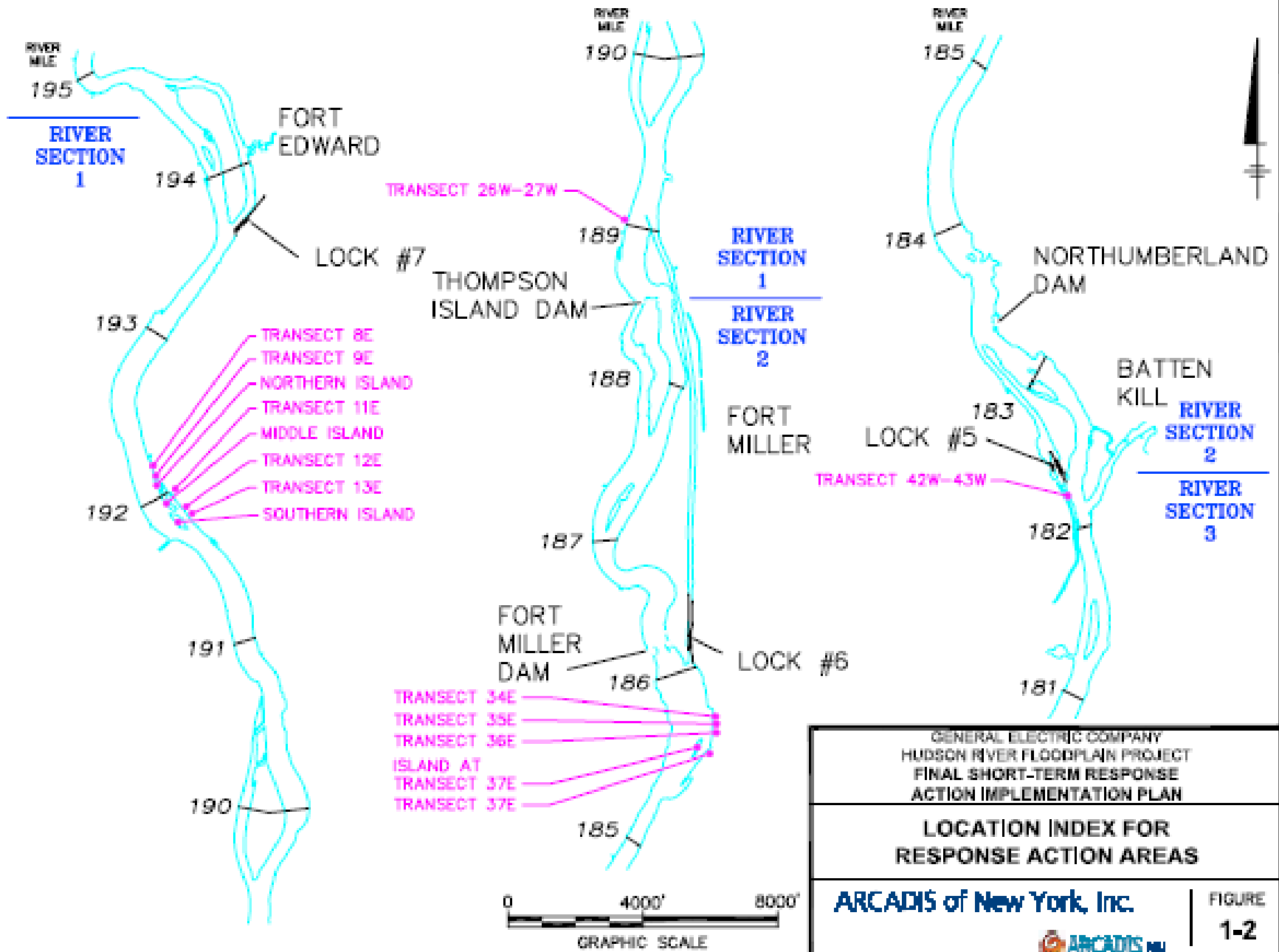

WARNING

SOILS IN THIS AREA ARE CONTAMINATED WITH
PCBs

(POLYCHLORINATED BIPHENYLS)

AVOID CONTACTING AND/OR DISTURBING SOILS

FOR FURTHER INFORMATION PLEASE CONTACT
THE USEPA FIELD OFFICE AT (518) 747-4389 OR
LOG ONTO THE USEPA HUDSON RIVER PCBs
WEBSITE AT <http://www.epa.gov/udson>



Hudson River
PCBs SUPERFUND SITE



Hudson River
PCBs SUPERFUND SITE





Questions / Comments

